

N° 4 areas free of warnish protected with Alodine 1200

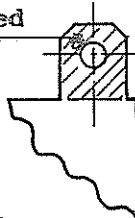

Connector MS27508E12-35P or equiv.
mating MS27484T 12-35S

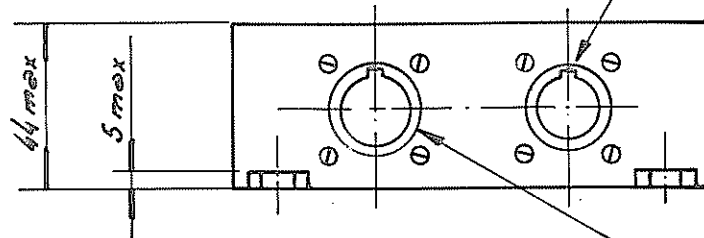

Connector MS27508E14-35P or equiv.
mating MS27484T14-35S

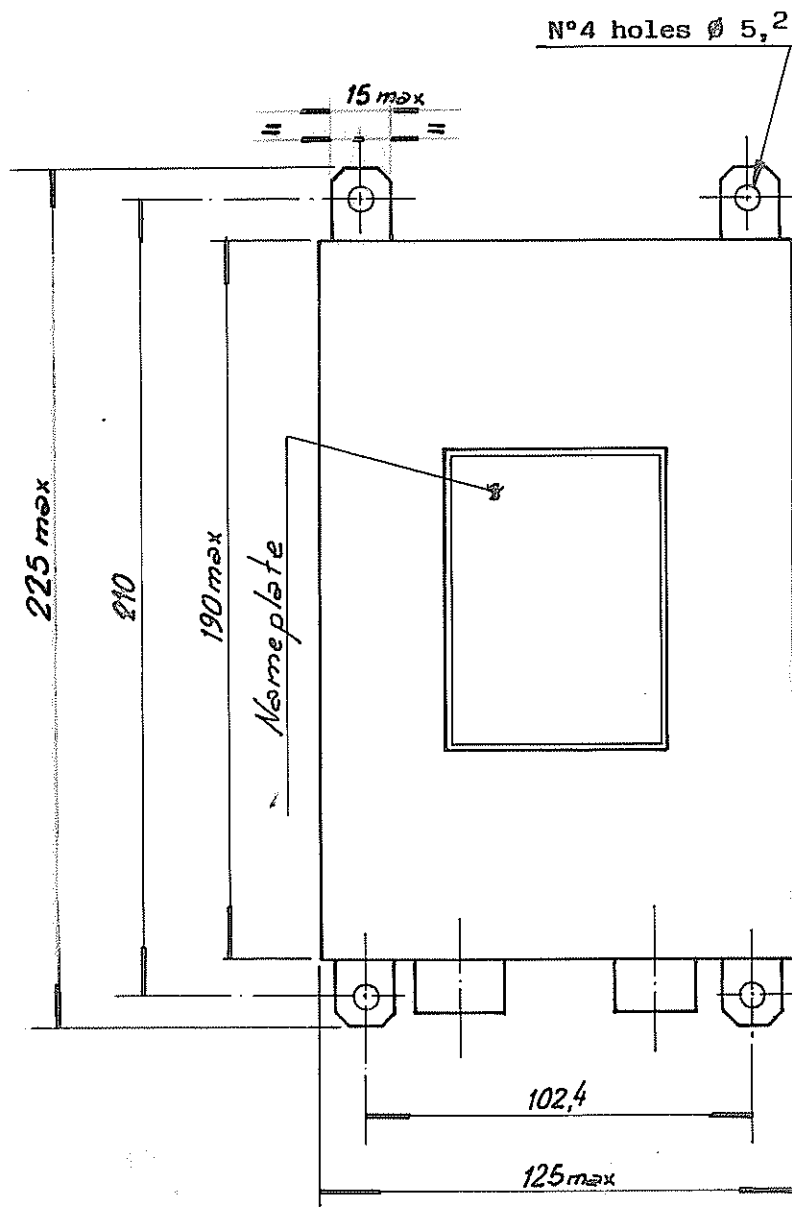

CONNECTOR PINS

J1

1. + 28 VDC power supply
2. RTN 28 VDC power supply
3. Main out signal (analogue)
4. Aux out signal (analogue)
5. Analogue return signal
6. Valid data
7. Return data
8. Clock data
9. Data signal
10. Data return signal
11. Self test input
- 12.
- 13.
- 14.
- 15.
16. Calibration selection signal
17. Calibration data enter
18. GND signal
19. Low level switch (H)
20. Low level switch (L)
- 21.
22. GND
23. GND
24. GND
25. GND
26. Channel selection signal
27. Increment data signal
28. Decrement data signal
29. Read ADJ data signal
- 30.
- 31.
- 32.
- 33.
- 34.
- 35.
- 36.
37. Case GND

Calibration only

Calibration only

J2

1. Shield (compensator)
2. Compensator signal (main)
3. Compensator shield
4. RH probe fuel signal (main)
5. RH shield
6. LH probe fuel signal (main)
7. LH shield
8. Aux XMTR fuel signal
- 9.
10. RH probe power supply
11. LH probe power supply
12. Fuel flow power supply
13. Fuel flow signal
14. Temperature signal
15. Shield
16. Shield
17. Shield
18. RTN Aux XMTR signal
- 19.
- 20.
21. "F.F." signal GND
- 22.

Dimensione are in mm

Ridisegnato il 13-4-88

| | | | | | |
|----------------------|--|------------------------------------|---------|-----------|---------------|
| DISEGNATORE | QUESTO DISEGNO / SPECIFICA RILASCIATO DALLA FAREM È STRETTAMENTE CONFIDENZIALE. NON PUÒ ESSERE RIPRODOTTO O DIVULGATO IN ALCUN MODO, SENZA L'AUTORIZZAZIONE SCRITTA DELLA DITTA. | | | | |
| CONTROLLI | TOLLERANZA SULLE MISURE ± 0,1 - SUGLI ANGOLI 1/2° - SEGNI DI LAVORAZIONE DOVE NON È SEGNATO DIVERSAMENTE | | | | |
| DATA 21-7-87 | MATERIALE // | | | | |
| SCALA 1:2 | FINITURA // | | | | |
| QUANTITÀ N° // | FAREM SESTO S. GIOVANNI | 1 | 13-4-88 | 3844 | |
| PESO | FUEL AND FLOW CONDITIONING | N° | DATA | MODIFICHE | DISEGN. APPR. |
| | | DISEGNO N° PN 19XG04 - TYP 1395 | | | |
| | | ORIGINE | | | |